

goccia
ILLUMINAZIONE

DART



KYKLO

light



DISEGNO DELLA LUCE

DESIGN OF THE LIGHT

Quando il progetto di design prende il via dall'intuizione, l'ingegnerizzazione segue il processo fino a definire l'estetica e la realizzazione - la forma segue la funzione, ma entrambe seguono la luce. E la luce è allo stesso tempo il fine ultimo e la spinta di ricerca originaria.

When the design project starts from intuition, the engineering follows the process until it defines the aesthetics and the realization - the form follows the function, but both follow the light. And light is at the same time the ultimate goal and the original drive of the research.

INCASSI A TERRA,
A PARETE,
DOWNLIGHT E SPOT

GROUND, WALL,
CEILING RECESSED
AND SPOTLIGHT

DART



Nell'illuminazione esterna l'effetto scenico e d'accento offre luminose possibilità di espressione. DART è la serie concepita con questo scopo, nella luce puntuale di spazi all'aperto residenziali. Le ridottissime dimensioni degli apparecchi si inseriscono in ambiti svariati con una presenza d'impatto minimo. La resistenza resta massima, grazie all'impiego di materiali di altissima qualità: l'alluminio tornito e anodizzato per tutte le parti, con versioni in acciaio inossidabile per anelli e calotte di chiusura. E anche la luce resta massimizzata: i LED ad alta efficienza sono abbinati alle diverse ottiche a disposizione, tenendo in grande considerazione il comfort visivo nelle tonalità e nell'antiabbagliamento.

La varietà delle versioni ad incasso si completa con i piccolissimi proiettori per enfatizzare con precisione lo scenario di giardini ed aree all'aperto.

In outdoor lighting, scenic and accent effects offer bright possibilities of expression. DART is the series designed for this purpose, in the spotlighting of residential outdoor spaces. The very small dimensions of the luminaires fit into a variety of applications with minimal impact. Resistance remains maximised, thanks to the use of the highest quality materials: turned and anodised aluminium for all parts, with stainless steel versions for closing rings and caps. And the light also remains maximised: high-efficiency LEDs are combined with the various optics available, with great consideration being given to visual comfort in terms of tonality and glare-free shielding.

The variety of the recessed versions is rounded off by the very small spotlights to precisely emphasise the scenery in gardens and outdoor areas.

UPLIGHT - DOWNLIGHT - STEPLIGHT



DART
Ø 23



DART
Ø 35



DART
Ø 55

SIDELIGHT



DART SIDE
Ø 40



DART SIDE
Ø 60

SPOTLIGHT



DART SPOT
Ø 16



DART SPOT
Ø 27



DART SPOT
Ø 46



DART SPOT
Ø 19



DART SPOT
Ø 30



DART SPOT
Ø 49

DART



Materiali e ottiche

Anelli di chiusura in alluminio tornito o acciaio inox AISI 316L su corpi in alluminio tornito. Ottiche selezionabili per diverse aperture del fascio luminoso.

Materials and optics

Covering rings in turned aluminium or AISI 316L stainless steel. Selectable optics for different light beam angles.

DART SIDE



Ottica side emitter

LED con ottica side emitter per indirizzare la luce lateralmente.

Side emitter optic

LED with side emitter optic to direct the light laterally.

Schermatura antiabbagliante

Riduzione dell'abbagliamento diretto grazie alle calotte schermanti in alluminio o acciaio inox.

Anti-glare shielding

Reduction of direct dazzle thanks to the shielding caps in aluminium or stainless steel.

Struttura

Solida struttura in alluminio tornito anticorrosivo anodizzato per la massima resistenza. Cavo in dotazione.

Structure

Solid structure in turned anticorrosive anodized aluminium for maximum resistance. Cable included.

DART SPOT

Visiera antiabbagliante

Elegante rivestimento in alluminio estruso anticorrosivo anodizzato con funzione di schermatura.

Anti-glare shield

Elegant anodized anticorrosive extruded aluminum covering with shielding function.

Minime dimensioni

Tecnologia LED e ottiche miniaturizzate. Anche con driver 230V integrato!

Minimal dimensions

Miniaturized LED technology and optics. Even with integrated 230V driver!



DART

Incasso a terra, a parete e soffitto / Ground, wall and ceiling recessed



DART Ø 23 mm

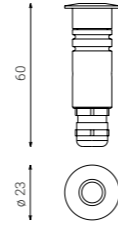

Code	Lamp	W	Real Lm	Optic	
1623	OS - natural anodization	LED max 350mA	1,3	86	27K - 2700K
	ON - black anodization				3K - 3000K
	IN - stainless steel				4K - 4000K

Ottiche opzionali / Optional optics
15° (code + 15), 60° (code + 60)

Su richiesta / On request	
Diffusore opalizzato / Opalized diffuser	

DART

Incasso a terra, a parete e soffitto / Ground, wall and ceiling recessed



DART Ø 35 mm

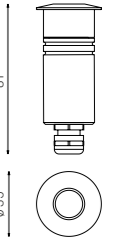

Code	Lamp	W	Real Lm	Optic	
1633	LED 350mA	2	126	27°	OS - natural anodization
					ON - black anodization
1634	LED 24V	2	126	27°	IN - stainless steel

Ottiche opzionali / Optional optics
11° (code + 11), 42° (code + 42)

Su richiesta / On request	
Diffusore opalizzato / Opalized diffuser	

CASSAFORME / RECESSED BOXES Ø 23 mm



code 1621



code 1622

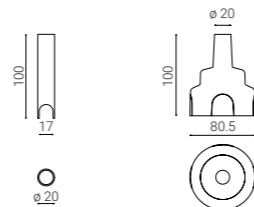

code 1621

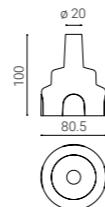

code 1622

Code	Description
1621	Cassaforma cilindrica Ø 23 mm in tecnopolimero / Cylindrical recessed box Ø 23 mm in technopolymer
1622	Cassaforma Ø 23 mm in tecnopolimero / Recessed box Ø 23 mm in technopolymer

CASSAFORME / RECESSED BOXES Ø 35 mm



code 1631



code 1632

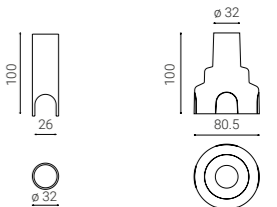

code 1631

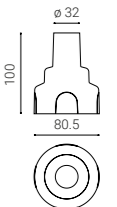

code 1632

Code	Description
1631	Cassaforma cilindrica Ø 35 mm in tecnopolimero / Cylindrical recessed box Ø 35 mm in technopolymer
1632	Cassaforma Ø 35 mm in tecnopolimero / Recessed box Ø 35 mm in technopolymer

DART

Incasso a terra, a parete e soffitto / Ground, wall and ceiling recessed



DART Ø 55 mm

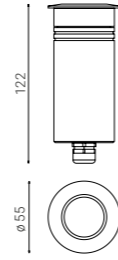

Code	Color	Temperature
1653	OS - natural anodization	27K - 2700K
	ON - black anodization	3K - 3000K
1654	IN - stainless steel	4K - 4000K

Lamp	Class	W	Real Lm	Optic
LED 230V	I	4	355	30°
LED 24V	III			

Ottiche opzionali / Optional optics
10° (code + 10), 54° (code + 54)

Su richiesta / On request
Diffusore opalizzato / Opalized diffuser

CASSAFORME / RECESSED BOXES Ø 55 mm



code 1651



code 1652

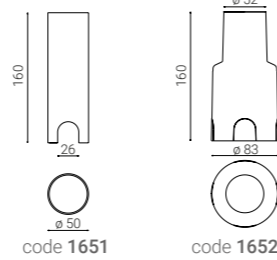

Code	Description
1651	Cassaforma cilindrica Ø 55 mm in tecnopolimero / Cylindrical recessed box Ø 55 mm in technopolymer
1652	Cassaforma Ø 55 mm in tecnopolimero / Recessed box Ø 55 mm in technopolymer

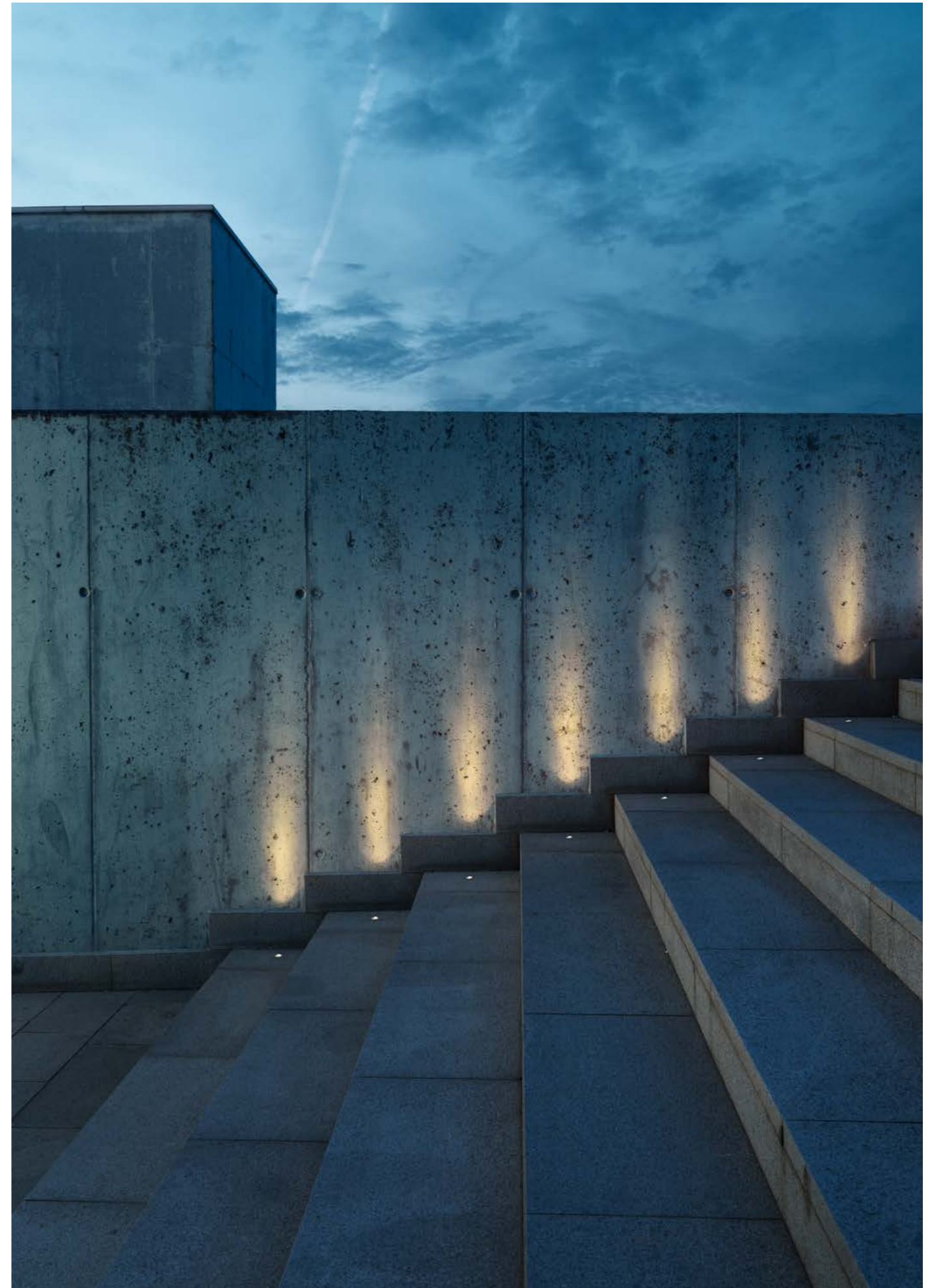

DART SIDE

Incasso a terra e parete / Ground and wall recessed



DART SIDE Ø 40 mm

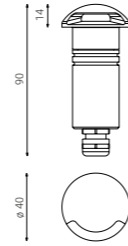

Code	Lamp	W	Real Lm	Optic
1640	LED 350mA	2	20	1x120°
1641	LED 24V			

DART SIDE Ø 40 mm

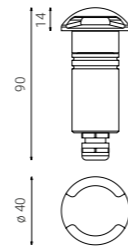

Code	Lamp	W	Real Lm	Optic
1642	LED 350mA	2	40	2x120°
1643	LED 24V			

CASSAFORME / RECESSED BOXES Ø 40 mm



code 1631



code 1632

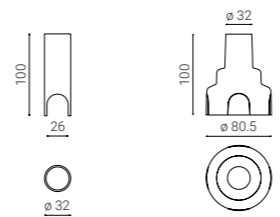

code 1631

code 1632

Code	Description
1631	Cassaforma cilindrica Ø 40 mm in tecnopolimero / Cylindrical recessed box Ø 40 mm in technopolymer
1632	Cassaforma Ø 40 mm in tecnopolimero / Recessed box Ø 40 mm in technopolymer

DART SIDE

Incasso a terra e parete / Ground and wall recessed



DART SIDE Ø 60 mm

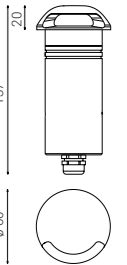

Code	Lamp	Class	W	Real Lm	Optic
1661	LED 230V	I	5	135	1x120°
1662	LED 24V				

DART SIDE Ø 60 mm

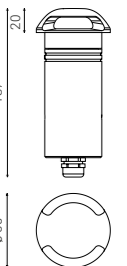

Code	Lamp	Class	W	Real Lm	Optic
1663	LED 230V	I	5	270	2x120°
1664	LED 24V				

CASSAFORME / RECESSED BOXES Ø 60 mm



code 1651



code 1652

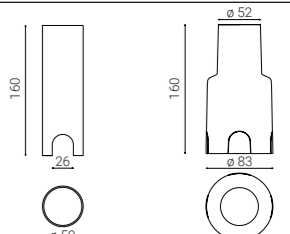

code 1651

code 1652

Code	Description
1651	Cassaforma cilindrica Ø 60 mm in tecnopolimero / Cylindrical recessed box Ø 60 mm in technopolymer
1652	Cassaforma Ø 60 mm in tecnopolimero / Recessed box Ø 60 mm in technopolymer



DART SPOT

Spotlight



DART SPOT Ø 16 mm

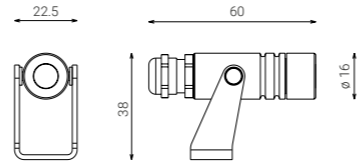

Code		Lamp	W	Real Lm	Optic
1610	● ON - black anodization	LED max 350mA	1,3	86	35°
	● 27K - 2700K				
	● 3K - 3000K ● 4K - 4000K				

Ottiche opzionali / Optional optics
15° (code + 15), 60° (code + 60)

DART SPOT

Spotlight



DART SPOT Ø 27 mm

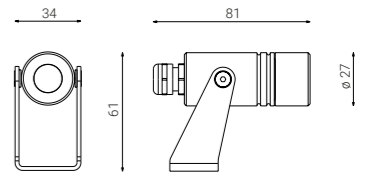

Code		Lamp	W	Real Lm	Optic
1612	● ON - black anodization	LED 350mA	2	126	27°
		LED 24V			
1613					

Ottiche opzionali / Optional optics
11° (code + 11), 42° (code + 42)

DART SPOT Ø 19 mm



natural anodization

black anodization

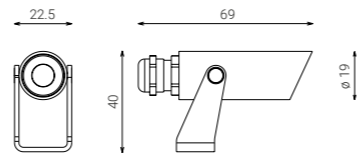

Code		Lamp	W	Real Lm	Optic
1611	● OS - natural anodization	LED max 350mA	1,3	86	35°
	● ON - black anodization				
	● 27K - 2700K ● 3K - 3000K ● 4K - 4000K				

Ottiche opzionali / Optional optics
15° (code + 15), 60° (code + 60)

DART SPOT Ø 30 mm



natural anodization

black anodization

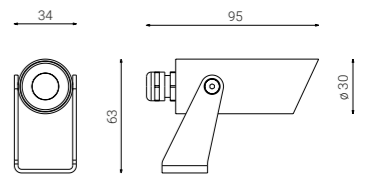

Code		Lamp	W	Real Lm	Optic
1614	● OS - natural anodization	LED 350mA	2	126	27°
		LED 24V			
1615	● ON - black anodization				

Ottiche opzionali / Optional optics
11° (code + 11), 42° (code + 42)

DART SPOT

Spotlight



DART SPOT Ø 46 mm

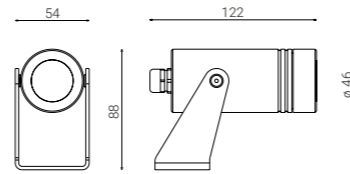

Code	
1616	● ON - black anodization
1617	● ON - black anodization

27K - 2700K
3K - 3000K
4K - 4000K

Lamp	Class	W	Real Lm	Optic
LED 230V	I	4	355	30°
LED 24V	III			

Ottiche opzionali / Optional optics

10° (code + 10), 54° (code + 54)

DART SPOT Ø 49 mm



natural anodization

black anodization

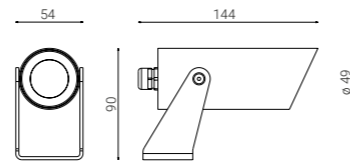

Code	
1618	● OS - natural anodization
1619	● ON - black anodization

27K - 2700K
3K - 3000K
4K - 4000K

Lamp	Class	W	Real Lm	Optic
LED 230V	I	4	355	30°
LED 24V	III			

Ottiche opzionali / Optional optics

10° (code + 10), 54° (code + 54)

DART SPOT

Accessori / Accessories



PICCHETTO / SPIKE



Code	Description
1600	Picchetto da giardino / Garden spike

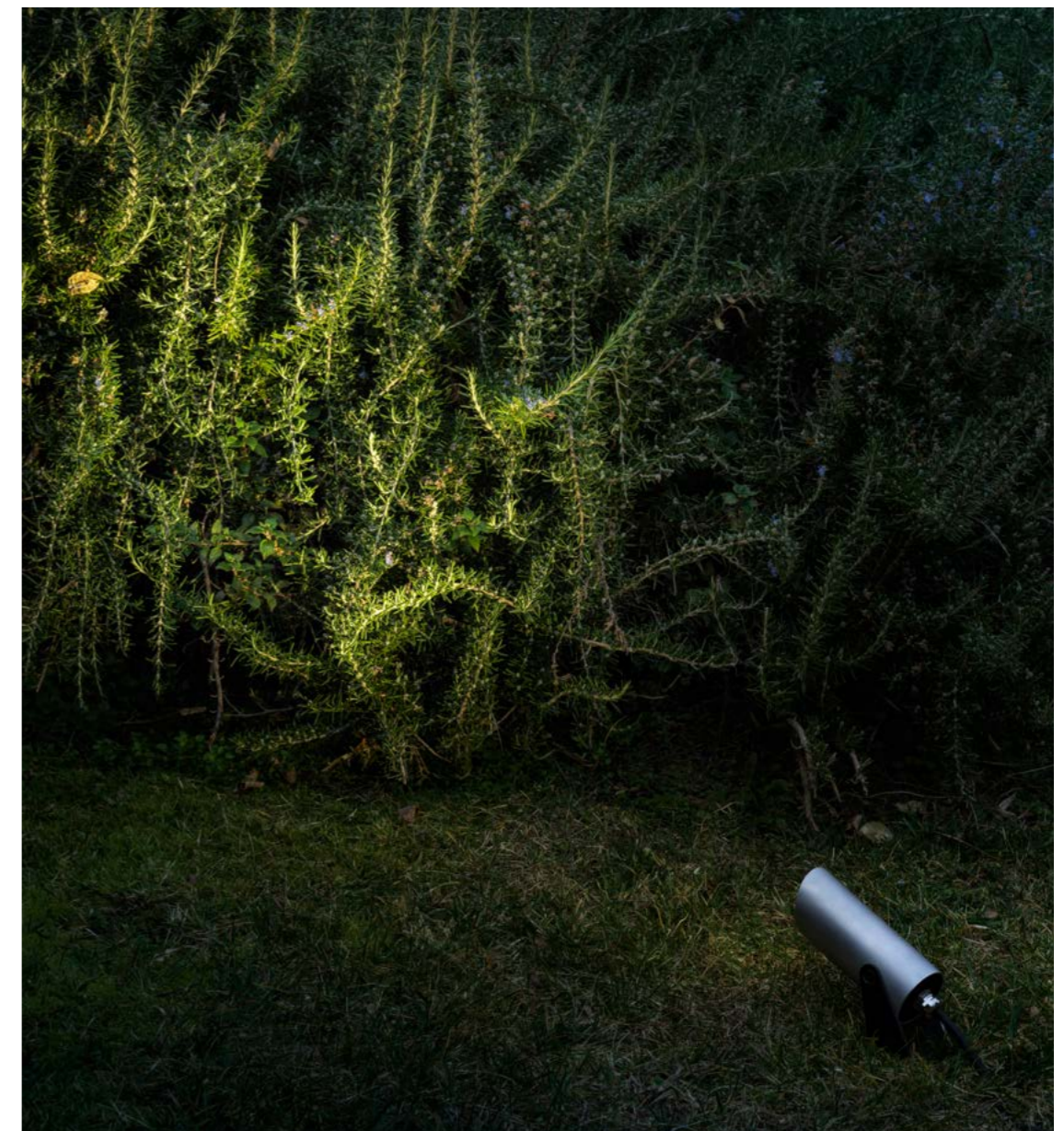

SEGNAPASSI,
EFFETTI A PARETE
E DOWNLIGHT

STEPLIGHT,
WALL EFFECTS
AND DOWNLIGHT

KYKLO



Il cerchio rappresenta l'unione compositiva della serie KYKLO, in cui le diverse versioni trovano in questa forma pura lo spazio della sorgente luminosa, nelle sue possibili espressioni, sottolineata dalla accurata lavorazione del diffusore in vetro a filo.

La forma del cerchio si presta così ad applicazioni per l'illuminazione da esterno classiche e moderne, con un disegno chiaro e riconoscibile che si articola in KYKLO STEPLIGHT, KYKLO APPLIQUE e KYKLO DOWNLIGHT. L'alta qualità dei materiali e dei dettagli delle forme danno spazio a sorgenti luminose LED e ottiche studiate per ogni impiego – nell'illuminazione di spazi architettonici esterni KYKLO rappresenta una serie versatile nell'essenzialità del motivo circolare.

The circle represents the compositional union of the KYKLO series, in which the different versions find in this pure form the space of the light source, in its possible expressions, underlined by the accurate finishing of the flush glass diffuser.

The circle shape is thus offered for classic and modern outdoor lighting applications, with a clear and recognisable design that is articulated in KYKLO STEPLIGHT, KYKLO APPLIQUE and KYKLO DOWNLIGHT. The high quality of the materials and details of the shapes give space to LED light sources and optics designed for every utilisation – in the lighting of outdoor architectural spaces KYKLO represents a versatile series in the essentiality of the circular motif.

STEPLIGHT



KYKLO STEPLIGHT
Ø 90



KYKLO STEPLIGHT
Ø 130

WALL EFFECTS



KYKLO APPLIQUE
Ø 90



KYKLO APPLIQUE
Ø 130

CEILING



KYKLO DOWNLIGHT
Ø 90 flat



KYKLO DOWNLIGHT
Ø 130 flat



KYKLO DOWNLIGHT
Ø 90



KYKLO DOWNLIGHT
Ø 130

KYKLO DOWNLIGHT

Vetro a filo struttura

Il diffusore circolare in vetro a filo col corpo lampada definisce un bordo raffinato che conferisce leggerezza ed uno stile inconfondibile.

Flush glass

The round glass diffuser flush with the lamp body defines a refined edge which adds lightness and a distinctive style.



Versione 230V
230V version

Struttura

Solida struttura in alluminio pressofuso a basso tenore di rame e viti inox. Sorgenti LED 230V dedicate e vetro temprato ultrawhite. Ingresso cavi dal retro.

Structure

Low copper content die-cast aluminium solid structure and stainless steel screws. Dedicated LED 230V sources and ultrawhite tempered glass. Rear cable entry.

KYKLO STEPLIGHT



KYKLO APPLIQUE



Altamente performante

Il disegno morbido e compatto ospita al suo interno tecnologia ad alta efficienza: le migliori ottiche per effetti a parete, LED ad elevato rendimento e driver 230V integrato o dimmerabile su richiesta.

Highly performing

The smooth and compact design houses high-efficiency technology: the best optics for wall effects, high-performance LEDs and integrated 230V driver or dimmable on request.

Minimo spessore

Il minimo spessore della lampada permette un'installazione a 230V di superficie.

Minimum thickness

The minimum thickness of the lamp is designed for 230V surface installation.

KYKLO STEPLIGHT

Lampade segnapasso / Steplight fittings



KYKLO STEPLIGHT Ø 90 mm

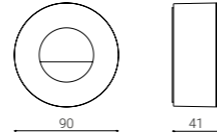

Code		
1230	● AN - anthracite	27K - 2700K
	○ BI - white	3K - 3000K 4K - 4000K

Modulo LED a tensione di rete, compatibile con dimmer a taglio di fase / Mains voltage LED module, compatible with most phase-cut dimmers

Lamp	W	Real Lm	Optic
LED	4	50	asym.

Su richiesta / On request
24V low voltage (code + 24V)

KYKLO STEPLIGHT Ø 130 mm

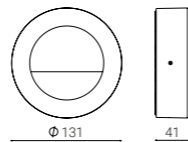

Code		
1240	● AN - anthracite	27K - 2700K
	○ BI - white	3K - 3000K 4K - 4000K

Modulo LED a tensione di rete, compatibile con dimmer a taglio di fase / Mains voltage LED module, compatible with most phase-cut dimmers

Lamp	W	Real Lm	Optic
LED	8	108	asym.

Su richiesta / On request
24V low voltage (code + 24V)

KYKLO STEPLIGHT

Accessori / Accessories



CONTROCASSE / BACKBOXES



code 1239

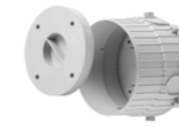

code 1249

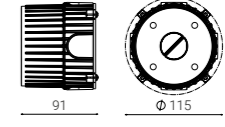

code 1239

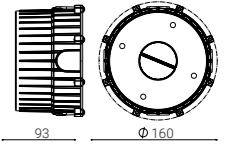

code 1249

Code	Description	Ref. to
1239	Controcassa per incasso totale, completa di coperchio / Backbox for wall flush installation, complete with cover	code 1230
1249		code 1240

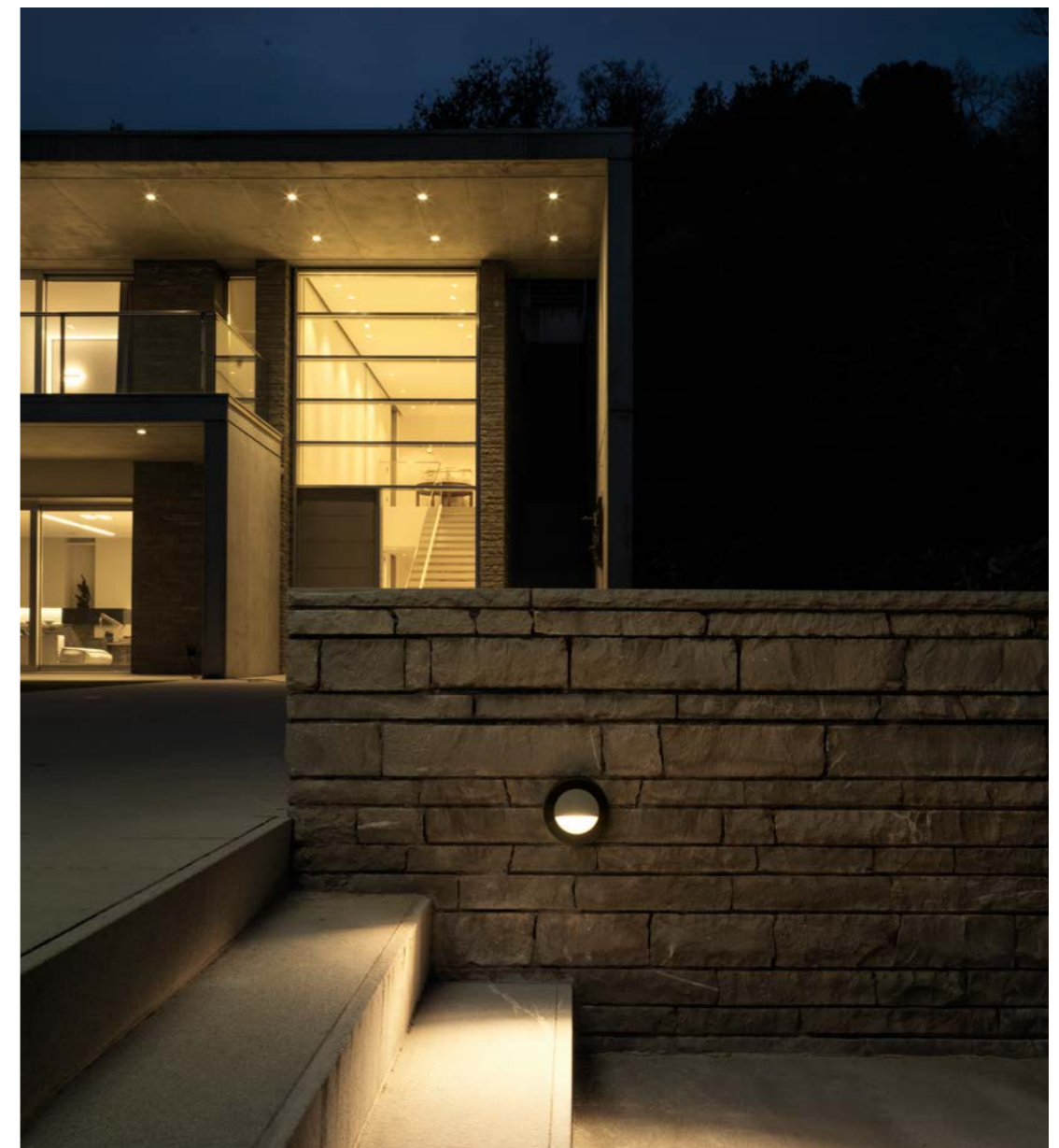



KYKLO APPLIQUE

Effetti a parete / Wall effects



KYKLO APPLIQUE Ø 90 mm

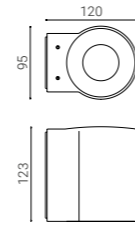

Code	
1250	<ul style="list-style-type: none"> ● AN - anthracite ○ BI - white
1251	-

Ottiche opzionali / Optional optics
1250 16° (code + 16), 60° (code + 60)

Lamp	W	Real Lm	Optic
LED	8	840	24°
GU 10	7 max	-	-

Su richiesta / On request
1250 Versione dimmerabile / Dimmable version
1250 24V low voltage (code + 24V)

KYKLO APPLIQUE Ø 130 mm

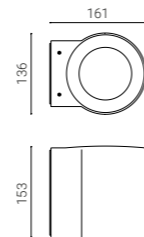

Code	
1260	<ul style="list-style-type: none"> ● AN - anthracite ○ BI - white

Ottiche opzionali / Optional optics 35° (code + 35)

Lamp	W	Real Lm	Optic
LED	19	2350	15°

Su richiesta / On request
Versione dimmerabile / Dimmable version

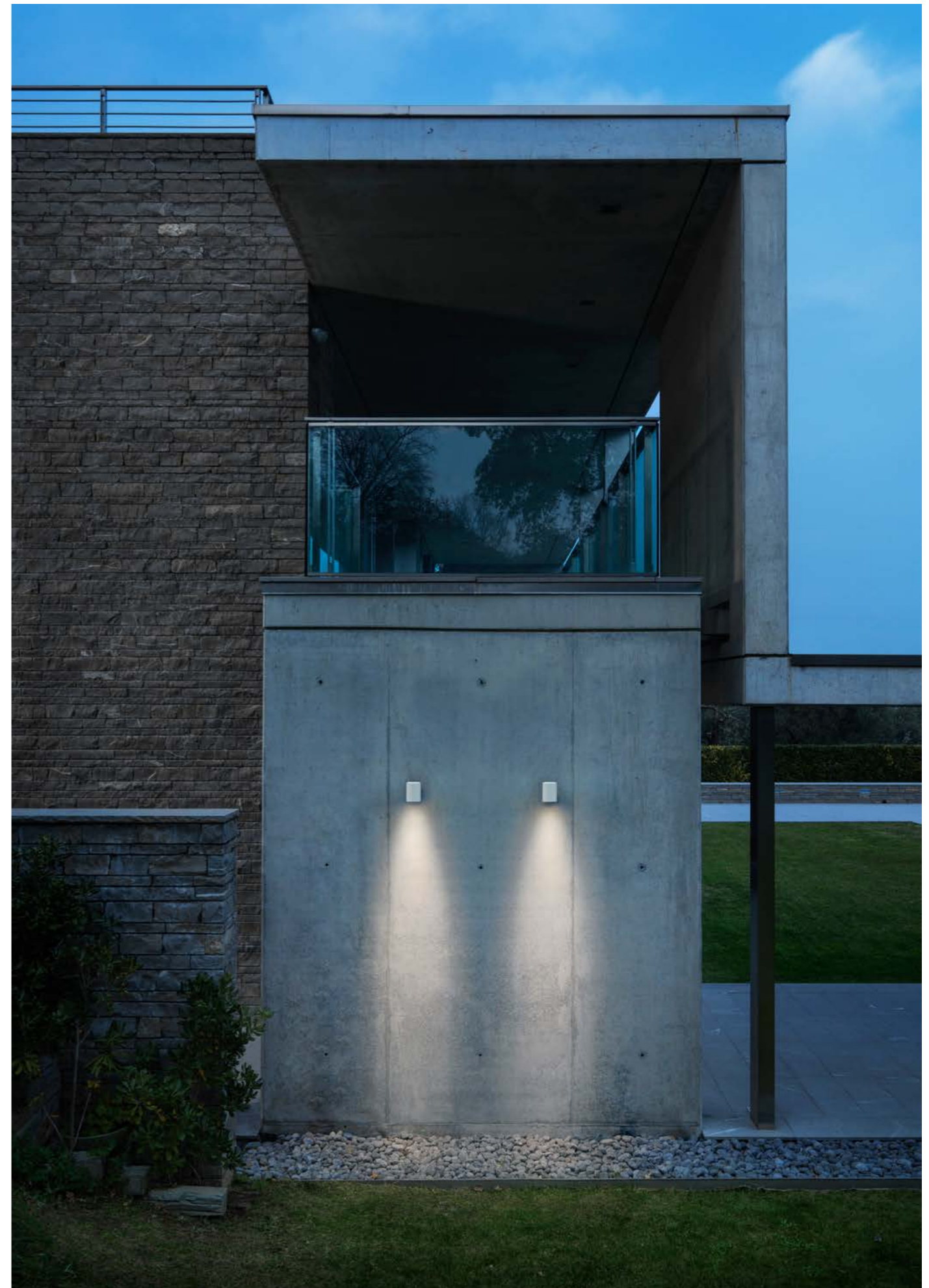

KYKLO DOWNLIGHT

Soffitto / Ceiling



KYKLO DOWNLIGHT Ø 90 mm FLAT



code 1233



code 1234

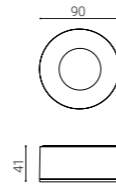

Code

Code	Color	Options
1233	● AN - anthracite	27K - 2700K 3K - 3000K
1234	○ BI - white	4K - 4000K

Ottiche opzionali / Optional optics
1233 12° (code + 12)
1234 Versione opale / Opal version

Lamp W Real Lm Optic

Lamp	W	Real Lm	Optic
LED	4	130	40°
		68	diffuse

Su richiesta / On request
24V low voltage (code + 24V)

KYKLO DOWNLIGHT

Accessori / Accessories



CONTROCASSE / BACKBOXES



code 1239



code 1249

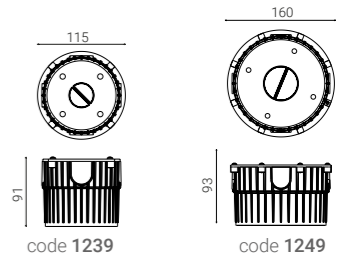

Code

1239
1249

Description

Controcassa per incasso totale, completa di coperchio / Backbox for wall flush installation, complete with cover	
--	--

Ref. to

code 1233
code 1234
code 1241
code 1242

KYKLO DOWNLIGHT Ø 130 mm FLAT



code 1241



code 1242

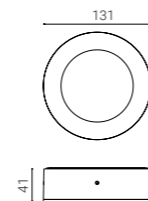

Code

Code	Color	Options
1241	● AN - anthracite	27K - 2700K 3K - 3000K
1242	○ BI - white	4K - 4000K

Ottiche opzionali / Optional optics
1241 12° (code + 12), 90° (code + 90)
1242 Versione opale / Opal version

Lamp W Real Lm Optic

Lamp	W	Real Lm	Optic
LED	10	750	40°
		363	diffuse

Su richiesta / On request
24V low voltage (code + 24V)
1241 Ottica a nido d'ape / Honeycomb optic 10° (code + HC)

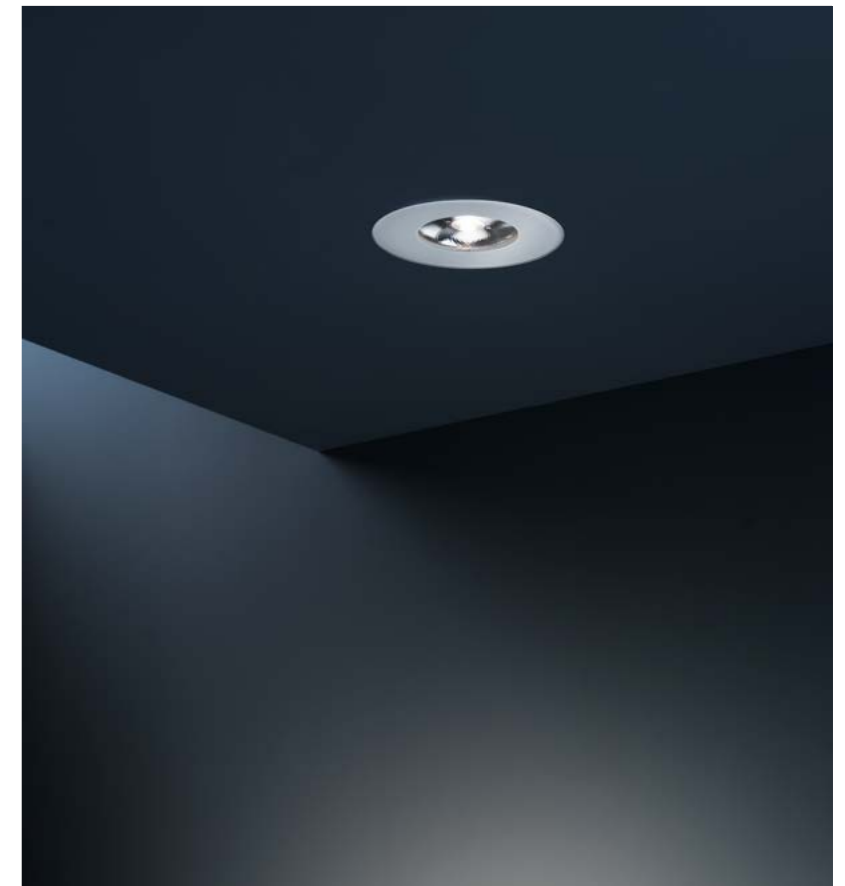

KYKLO DOWNLIGHT

Soffitto / Ceiling



KYKLO DOWNLIGHT Ø 90 mm

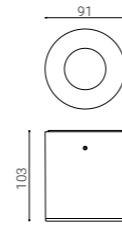

Code	
1235	<ul style="list-style-type: none"> ● AN - anthracite ○ BI - white
1236	-

Ottiche opzionali / Optional optics
1235 16° (code + 16), 60° (code + 60)

Lamp	W	Real Lm	Optic
LED	8	840	24°
GU10	7 max	-	-

Su richiesta / On request
1235 Versione dimmerabile / Dimmable version
1235 24V low voltage (code + 24V)

KYKLO DOWNLIGHT Ø 130 mm

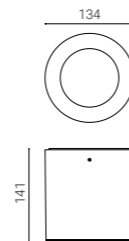

Code	
1243	<ul style="list-style-type: none"> ● AN - anthracite ○ BI - white

Ottiche opzionali / Optional optics 35° (code + 35)

Lamp	W	Real Lm	Optic
LED	19	2350	15°

Su richiesta / On request
Versione dimmerabile / Dimmable version
24V low voltage (code + 24V)

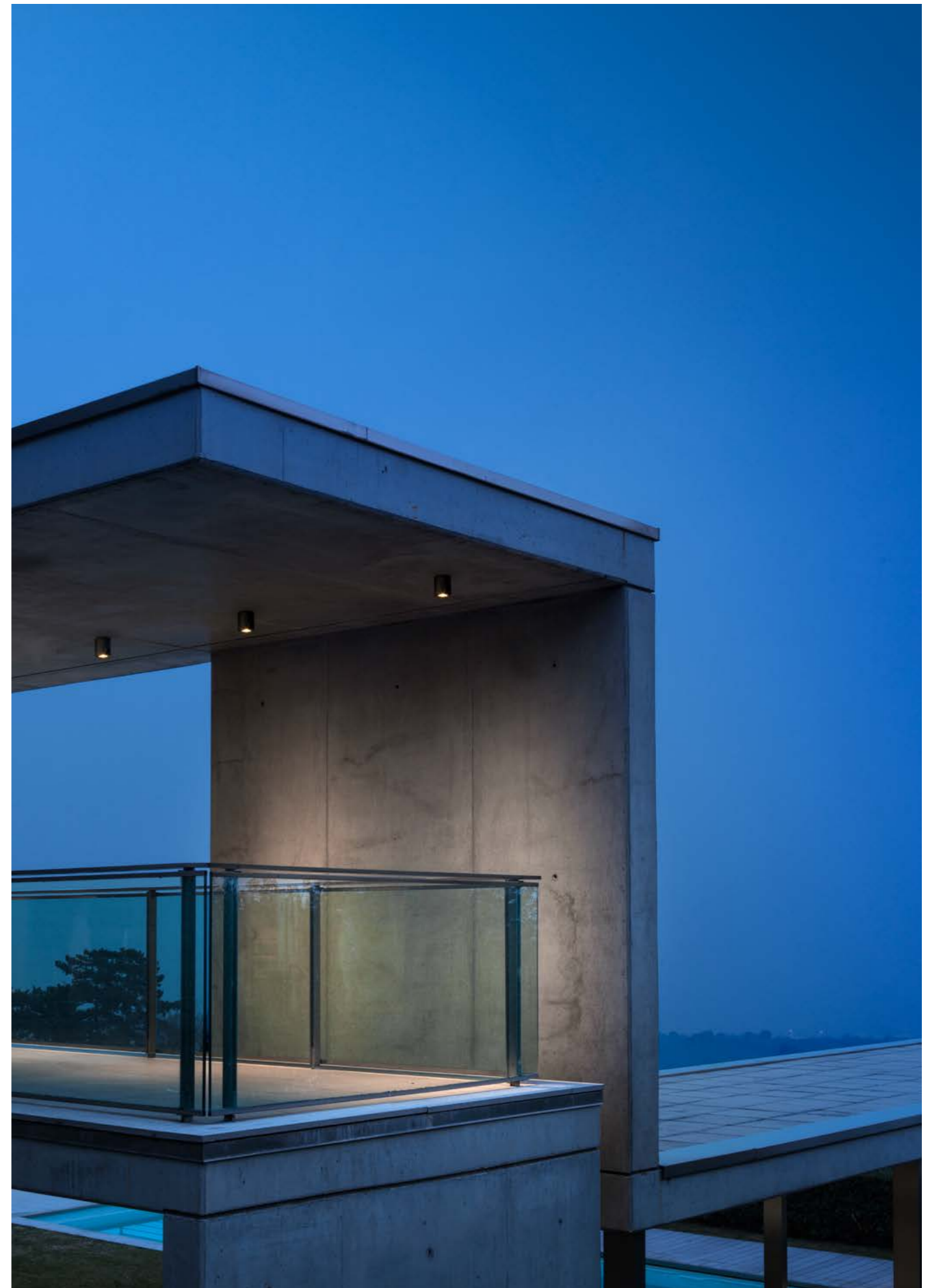



Concept: Vittoria Comunica® - Shooting: CubePhotoProduction

goccia
ILLUMINAZIONE

Consultate sul sito www.goccia.it il catalogo completo /
See the complete catalogue on www.goccia.it

Goccia Illuminazione srl

Via E. Fermi, 59/65
25020 Poncarale (BS) Italy
T. +39 030 26 40 761
F. +39 030 26 40 271

info@goccia.it

